

BCS-Liner

liner insertion machine

Automated production of liner
inserted bags

Easy changeover between Liner bags
& Normal Bags

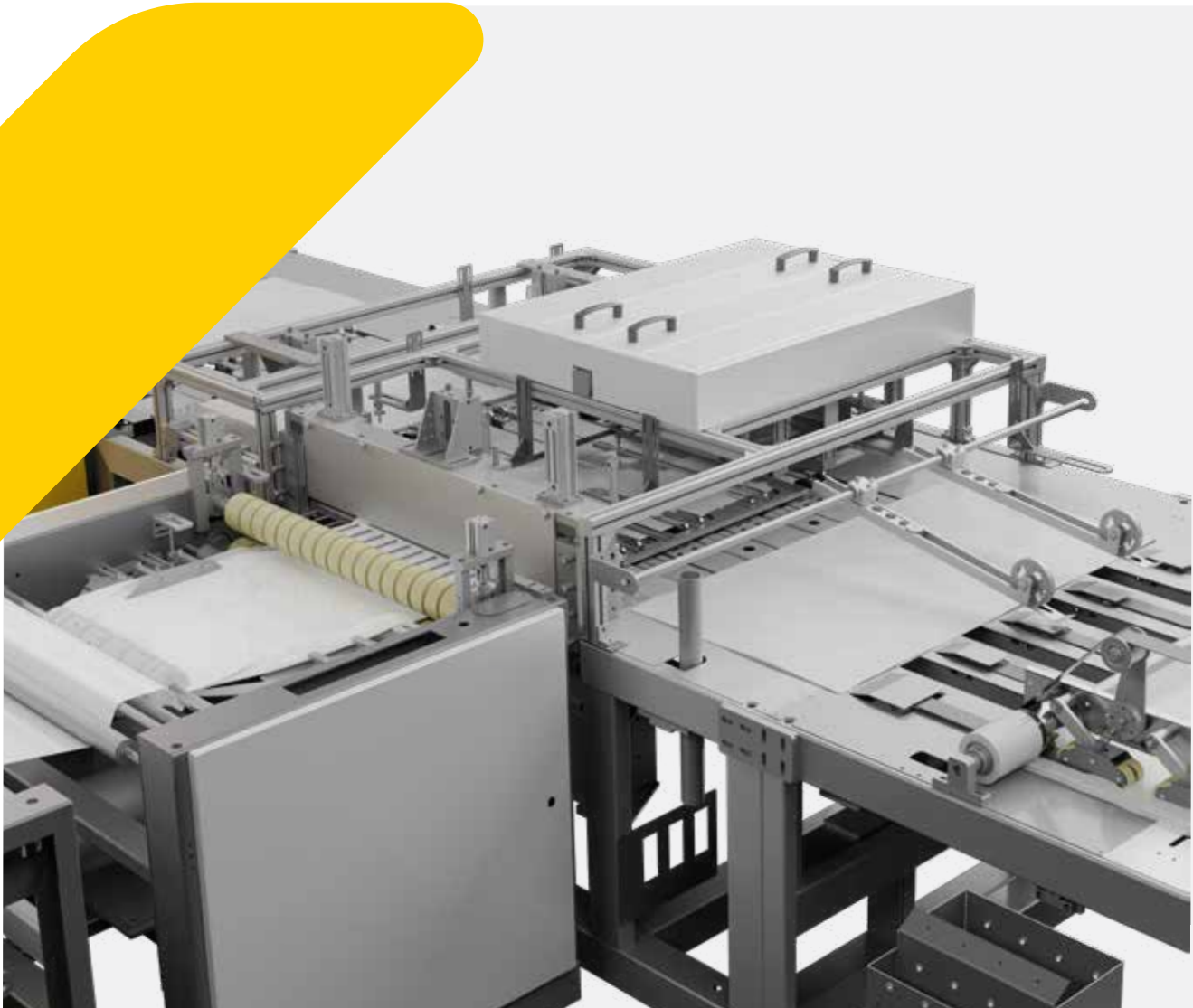

BCS-Liner

liner insertion machine

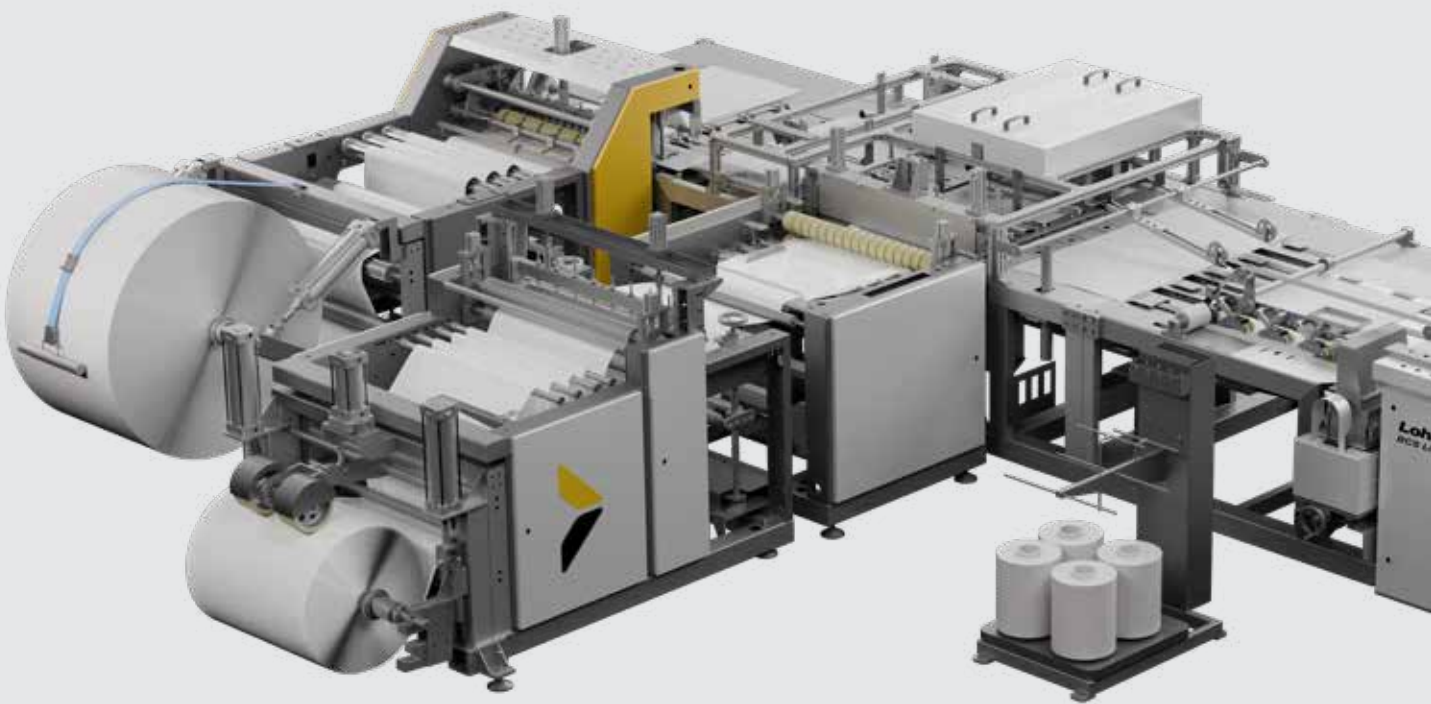

BCS-Liner is the latest addition in our range of conversion machines. It automates and replaces the manual process of inserting liner in the woven bags. The machine uses PE/HDPE/LLDPE rolls which are cut at desired length, sealed and inserted in the woven bags. It is suitable for non-laminated fabric with an option for laminated fabric. These Liner bags are used in packaging of hygroscopic materials such as sugar, salt, chemicals & minerals.

BCS Mode#: The operation can also be changed to normal fabric conversion mode with a press of button.

OPTIONAL EQUIPMENTS

- Cold cutting device (for laminated fabric)
- Static charge elimination device
- Perforation device
- Single folder
- Handle punch device
- Zig zag hot cutter

Produces bottom stitched liner inserted bags from tubular woven & liner fabric automatically



Production Speed
Upto 28 bags/min* in Liner mode
Upto 40 bags/min* in BCS mode

Unwinding Fabric Roll Width
400 - 750 for Liner insertion
300 - 800 in BCS mode

Cutting Length
600 - 1180 for Liner insertion
500 - 1225 in BCS mode

Cutting Length Accuracy
± 1 mm for unprinted fabric



UNWINDING UNIT

Edge Position Control Unit (EPC) automatically makes minor adjustments to align the web with precision.

Easy Mounting of the tubular woven fabric/liner roll without any external lifting device. Provision of mechanical break to maintain proper tension.



ACCUMULATOR UNIT

Accumulator unit keeps a reserve of extra length of fabric opened during continuous unwinding and helps in maintaining uniform tension of fabric.

Print Mark Sensor is supplied as standard with the machine to cut the fabric as per marking on the pre-printed fabric roll



BAG STACKING AND CONVEYOR UNIT

Auto Switch-Off: The sewing machine automatically stops when no cut lengths are received from cutting unit.

Variable Frequency Drive System synchronizes the

cutting unit, conveyor and sewing unit.

Thread Cutter Unit is operated through an electronic sensor for smooth operation.

Set Stack Quantities: The finished bags are discharged onto a delivery conveyor after counting and stacking the pre-set number of bags.



HOT SEALING/CUTTING UNIT

Hot Sealing Device helps in bottom sealing of cut liner length.

Cut Preset Length: The servo motor helps cutting the preset length of the fabric/liner with minimal variation. These cut lengths are then transferred inside the bottom stitched fabric bags.



INSERTION SYSTEM

Liner Inserting: The liner is inserted into the fabric through servo driven nip. It is spread across the fabric with air through the nozzles.

After liner insertion the bag delivered to the **Stacking Unit**.

BCS-Liner

liner insertion machine

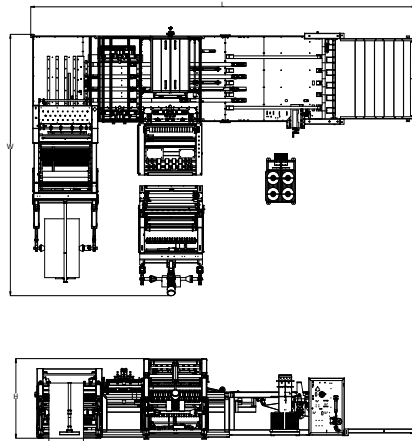

BCS-Liner(Air)

Width of Unwinding Fabric Roll	450 - 750 mm for Liner insertion 300 - 850 mm in BCS mode
Width of Unwinding Liner Roll	350 - 800 mm
Diameter of Fabric Roll	1300 mm
Internal Diameter of Core	70 - 115 mm**
Replacement of Fabric Roll	Pneumatic System
Cutting Length	600 – 1180 for Liner insertion 500 - 1225 in BCS mode
Cutting Length (Liner)	620 - 1225 mm
Cutting Length Accuracy	± 1 mm for Unprinted Fabric
Bottom Folding Width	Double 25 mm (Option - 22 mm) Single 25-30 mm
Stitching Type	Double Stitch
Range	4 - 9 mm for Bottom Stitch
Liner thickness	15 - 80µ***
Production Speed	Upto 28 bags / min* for Liner insertion Upto 40 bags / min* in BCS mode
Dimensions (L x W x H)	7.73 x 4.88 x 1.50 m

*Depends on width, quality of fabric used including winding & PP multifilament stitching yarn etc.

**Other options on request.

***Depends upon type/material of liner.

Cut length accuracy for printed fabric varies with deviation in cut mark. Specifications are subject to change without prior notice due to continuous development. details are indicative and not binding.

Extreme values indicated are not achievable simultaneously. The pictures may show optional equipments which are not a part of standard supply. For details, refer to the quotation.

HEAD OFFICE & WORKS

Lohia Corp Limited
D-3/A, Panki Industrial Estate
Kanpur - 208022, India

T: +91 512 3123222
E: sales@lohiagroup.com

W: lohiagroup.com

OFFICES IN INDIA

AHMEDABAD T: +91 79 47729820
BENGALURU T: +91 9792971135
DELHI T: +91 4071 4800
KOLKATA T: +91 33 35898700

OVERSEAS OFFICES & ASSOCIATES

BANGKOK T: +66 21305919
BURLINGTON-NC T: +54 9 11 6533 2950
DUBAI T: +9714 548 3200
ITAJAI-BRAZIL T: +55 51 93999193
MOSCOW T: +7 499 6150479